

Classificar as estruturas quanto ao grau de hiperestaticidade (verifique que os casos 5 e 8 são excepcionais por apresentarem mobilidade mesmo com número mínimo de barras simples necessário):

Obs.: o traço mais forte indica barra geral; o mais fino indica barra simples.

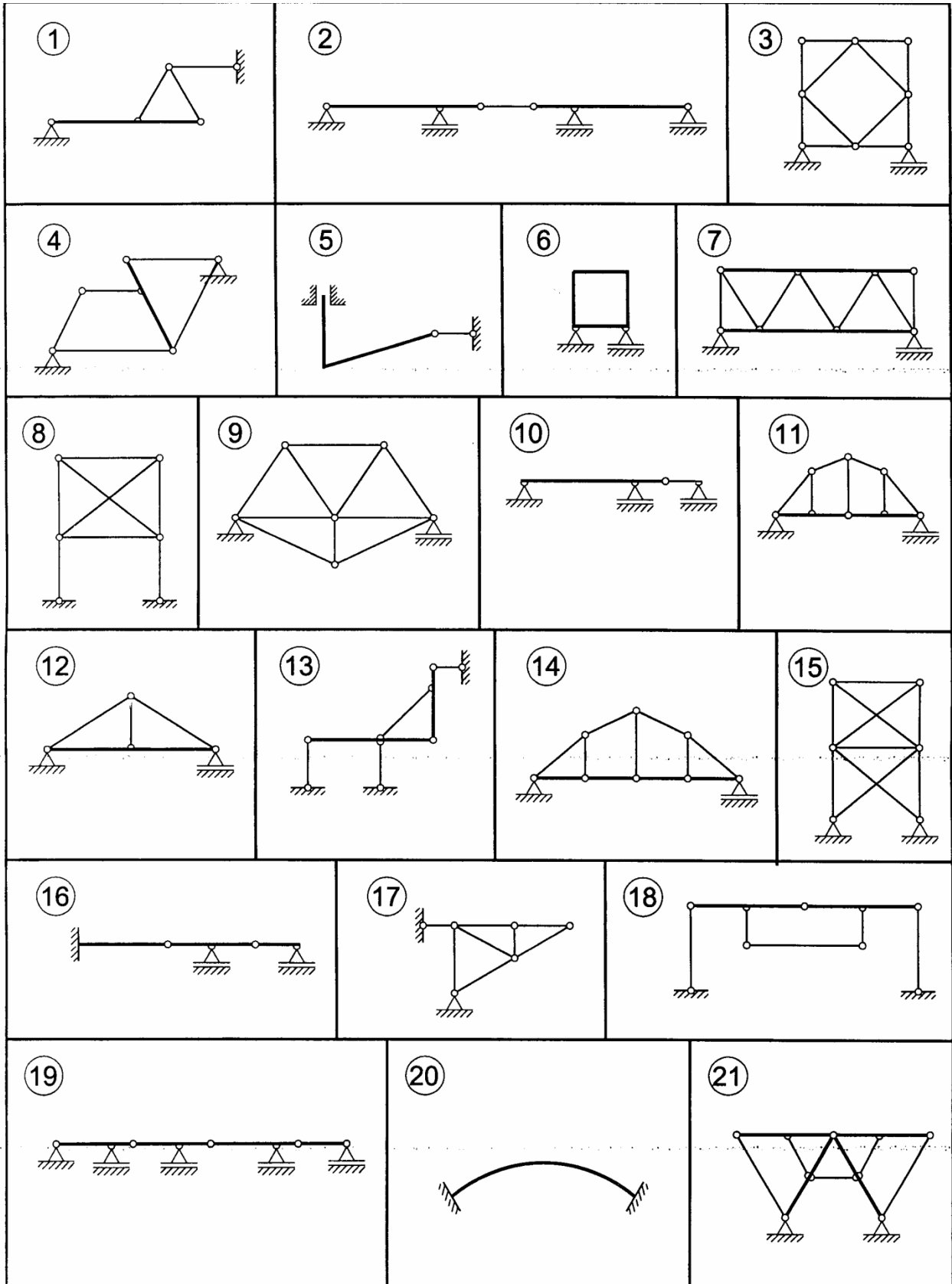

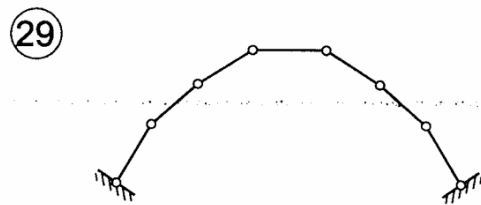
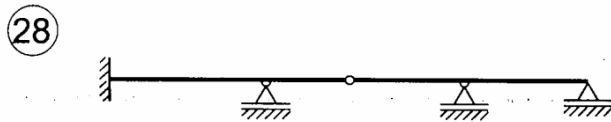
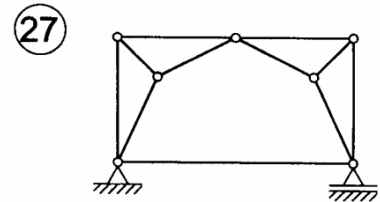
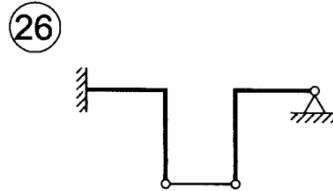
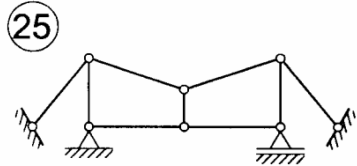
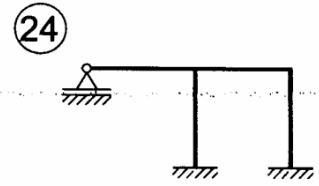
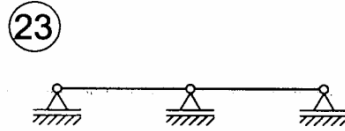
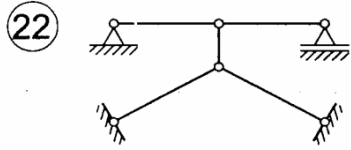

Classificar as estruturas quanto a determinação geométrica e transformá-la em isostáticas.

